



**SAN MATEO COUNTY  
COMMUNITY COLLEGE DISTRICT**

**FACILITIES MASTER PLAN**



**BOARD OF TRUSTEES**

JULY 27, 2022



# AGENDA

- 01 Process + Timeline
- 02 Planning Principles
- 03 Assessment + Opportunities
- 04 Long Term Vision
- 05 Feedback
- 06 Next Steps

# PROCESS + TIMELINE

---

01

# OUR TASK



CREATE A **COHESIVE VISION** FOR THE CAMPUS OVER TIME



TRANSLATE THE STRATEGIC AND EDUCATIONAL PLANS INTO A **PHYSICAL PLAN**



**SUPPORT** THE CAMPUS'S EVER-CHANGING NEEDS



ESTABLISH A **FRAMEWORK** FOR IMPLEMENTATION

# PLANNING PROCESS

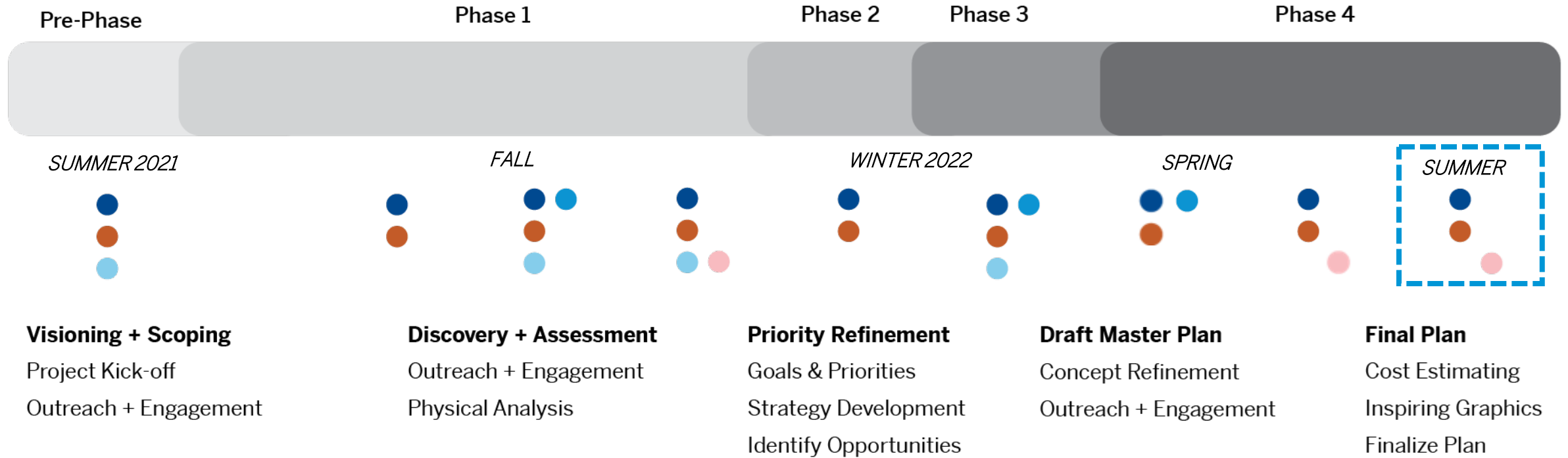

- District FMP Leadership
- President's Cabinets
- Involved Groups
- Community
- Board of Trustees

# ENGAGED GROUPS

## INVOLVED GROUPS

- Students
- Faculty & Staff
- Key Programs & Departments

## COMMUNITY

- Campus Community
- Greater Community

## BOARD OF TRUSTEES

## DISTRICT FMP LEADERSHIP

- Facilities District Office
- Chancellor's Council

## WORKING GROUP

- CIP/President's Cabinets
- Deans



Participants engaging via Zoom

# PLANNING PRINCIPLES

---

02

# PLANNING FOUNDATION

## Students First: District Strategic Planning Priorities

### Goal 1



Develop and strengthen educational offerings, interventions, and support programs that increase student access and success.

### Goal 2



Establish and expand relationships with school districts, 4-year college partners, and community-based organizations to increase higher education attainment in San Mateo County.

### Goal 3



Increase program delivery options, including the expanded use of instructional technology, to support student learning and success.

### Goal 4



Ensure necessary resources are available to implement this strategic plan through sound fiscal planning and management of allocations.

Protect community-supported status and undertake the development of innovative sources of revenue that support educational programs beyond that which is available from community and state allocations.



# CAÑADA EDUCATIONAL MASTER PLAN

2022-2027

## Goal 1

Student Access, Success and Completion

## Goal 2

Community Connections

## Goal 3

Equity-Minded and Antiracist College Culture

## Goal 4

Accessible Infrastructure and Innovation



# PLANNING PRINCIPLES

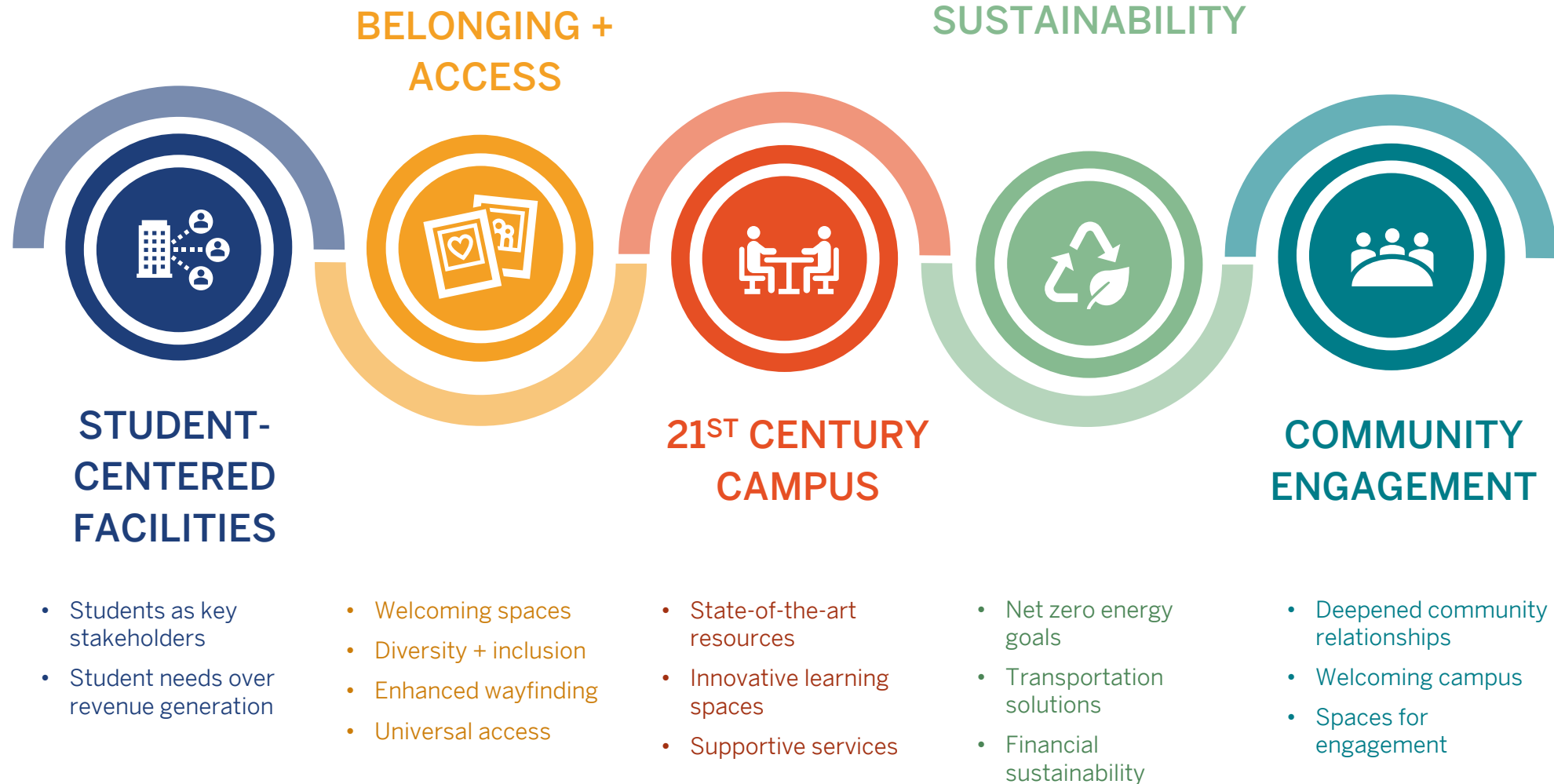

# COLLEGE GOALS

Foster a **sense of belonging** for students, faculty, staff, and community of all backgrounds

Maximize **flexibility** of facilities to serve ever-changing College needs

Develop welcoming and accessible affinity spaces that **support campus life**

Enhance **learning environments** to support multiple modalities

**Modernize** Performing Arts Center to better support Creative Arts programs

Reimagine the **future of the Library and Learning Center** to best connect students to services and resources

Enhance **wayfinding and pedestrian experience** throughout campus

**Strengthen connection** to the campus core

CAÑADA COLLEGE

Develop spaces to foster a sense of **belonging, collaboration and creativity** among the CSM Community

Serve as the community's center for **enrichment, civic engagement, health, and cultural well-being**

Improve **flexibility** of campus learning spaces

Provide **state-of-the-art resources** to students

**Modernize** the Gymnasium, Library, East Hall, and Center for Emerging Technologies to **support evolving needs**

Provide **supportive, accessible student housing** that is well-connected to campus network

Enhance **arrival and wayfinding** experience for all visitors

Be a leader in **renewable energy technologies**

COLLEGE OF SAN MATEO

Reinforce Skyline's identity as a **21st-century educational destination** for students

Promote **belonging, equity, and anti-racism** in student experience

Celebrate **interculturality** in visual identity with a campus-wide program of representational art and monuments

Enhance the **College's gateway** to welcome new students, visitors, and the greater community

**Modernize** Performing Arts Building, Library, and Pacific Heights to **support evolving needs**

Consider **long-term facilities needs** of Creative Arts, Kinesiology, and Athletics programs

Sustainably utilize existing facilities for **exciting and adaptable new uses**

Develop **celebratory, climate-adaptive** outdoor event spaces

SKYLINE COLLEGE

# WHAT WE HEARD FROM YOU

November 10, 2021 Board Meeting

June 16, 2022 Campus Tours

- **Student Housing** is a high priority
- Prioritize **sustainability** by pursuing campus electrification and alignment with regulatory requirements
- Important to understand the paradigm shift to **hybrid modes of instruction**
- Consider how to handle excess **classroom space** resulting from increased online learning
- Study **mobility**: where students are coming from and how they arrive to campus
- Recognize the work of the **accessibility plan**

# ASSESSMENTS + OPPORTUNITIES

---

03

# PROCESS

## Assessments + Opportunities

- **FACILITIES ASSESSMENT**
  - Preventative Maintenance
  - Planned Projects
  - Electrification Study
- **SPACE USE**
  - Classroom Optimization
  - Classroom Reuse Opportunities
  - HyFlex/Hybrid
- **WAYFINDING**
- **LONG TERM VISION**
  - Housing

# FACILITIES CONDITION

Cañada College

- Assessment surveyed every facility's structure, roofing, plumbing, HVAC, fire protection, accessibility, and more
- Data on system expenditure forecasts for the next 10 years to assist with project planning

Facilities Needs, 2022-2032

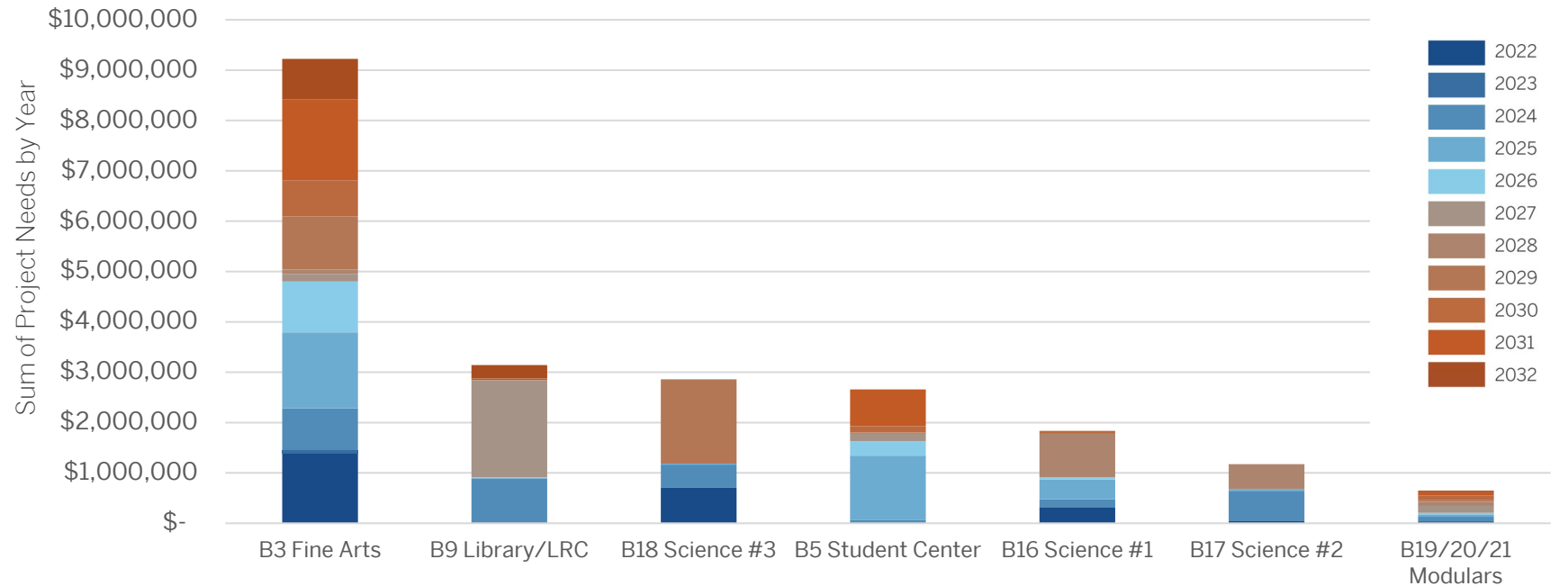

\* Only facilities with > \$500,000 of total work are represented.

4

buildings with critical projected **Facilities Condition Index (FCI)**

4

buildings with **over \$2m** in needs



41%

of total facilities needs relate to **B3 Fine Arts**

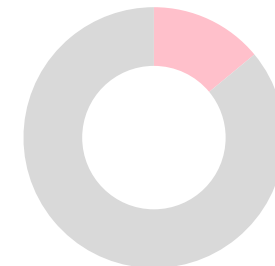

14%



of total facilities needs relate to **B9 Library/LRC**

# PLANNED PROJECTS

## Cañada College

- Buildings with ongoing/planned renovations:
  - B13 – Classrooms (FPP)\*
  - B3 - Performing Arts (IPP)\*
- Athletic Fields and Tennis Court Replacement

\* Included in 2023-2027 Five-Year Capital Construction Plan

-  Ongoing/Planned Renovation
-  Athletic Field Replacement

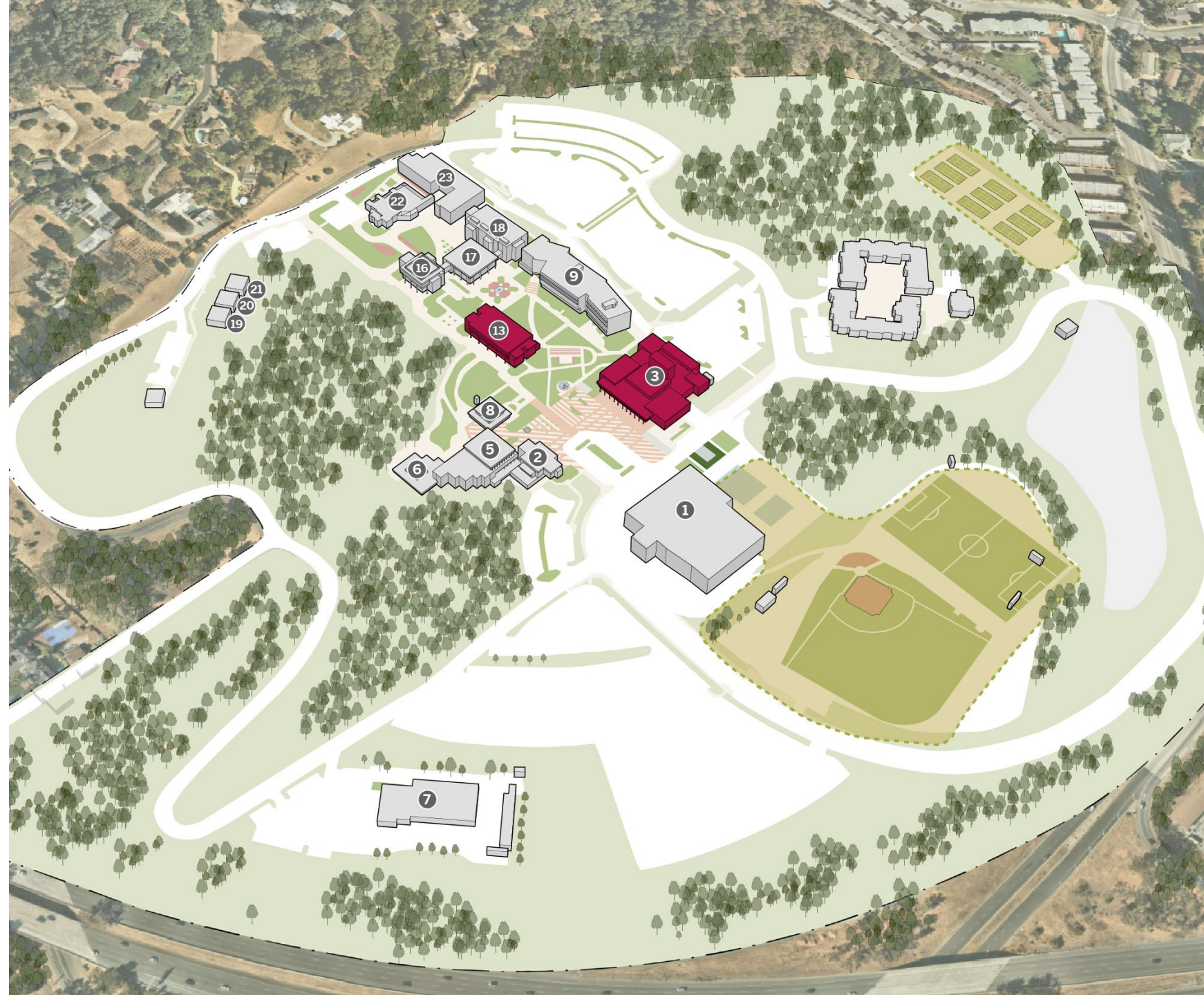



# ELECTRICAL INFRASTRUCTURE ASSESSMENT

- Colleges have adequate electrical capacity for future needs
- Recommended to prioritize:
  - EV Charging District Fleet and Commuter Expansion
  - PV Expansion at main switchgear
  - Adding new primary loop feeders
  - Electrical metering project
- Electrification Study to be finalized with recommendations this week

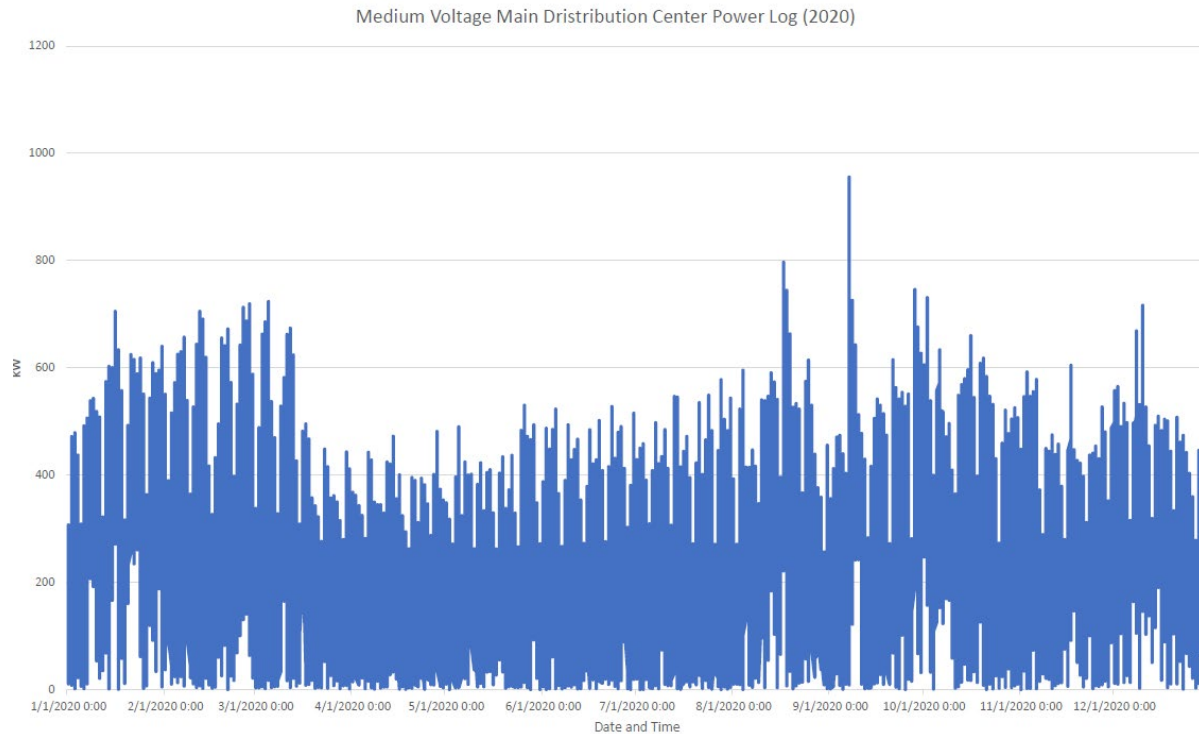

EV Chargers, CSM Lot 7

# SPACE USE

## Classroom Reuse Opportunities

- Opportunities to repurpose classrooms for other uses, such as meeting rooms, collaboration space, individual remote learning space,
- Allows for flexibility – repurposed rooms can easily be reverted to classrooms

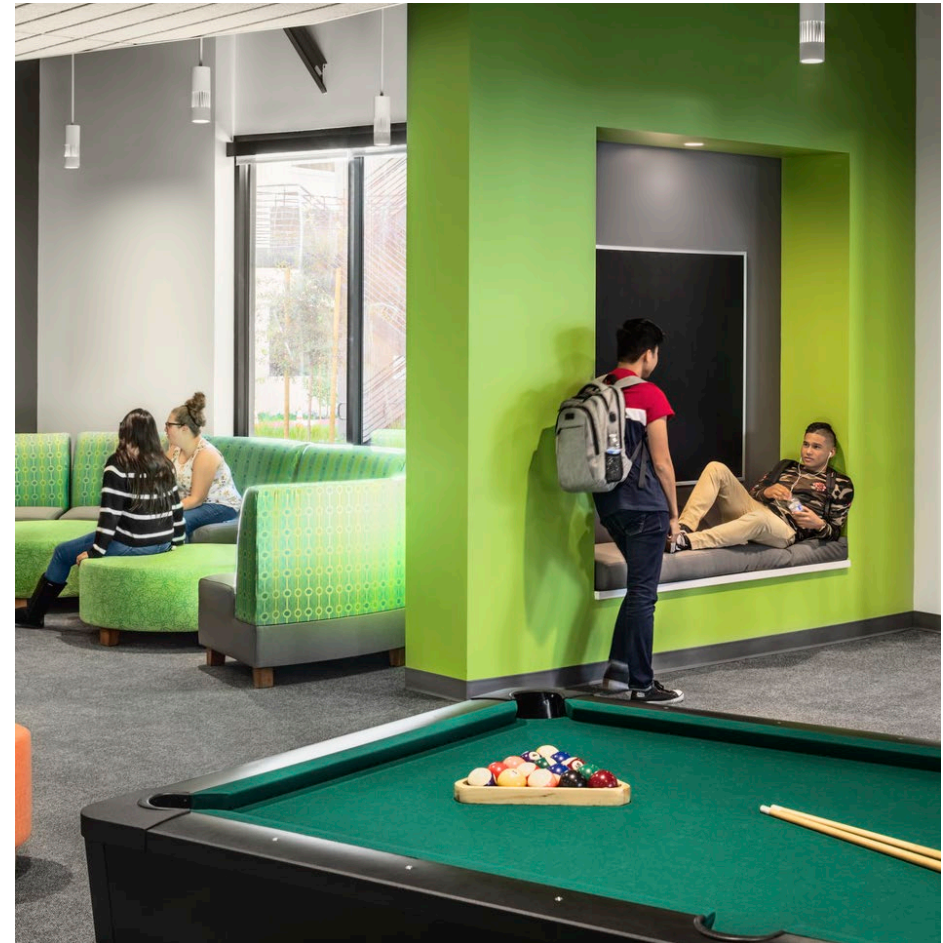

# SPACE USE

## Hyflex/Hybrid or Multi-Modal

- Upgrade classroom technology with the resources necessary to support multiple learning modalities
- Augment current distribution of hybrid/HyFlex classrooms with additional locations
  - Take advantage of current/upcoming building renovations to upgrade technology + furniture

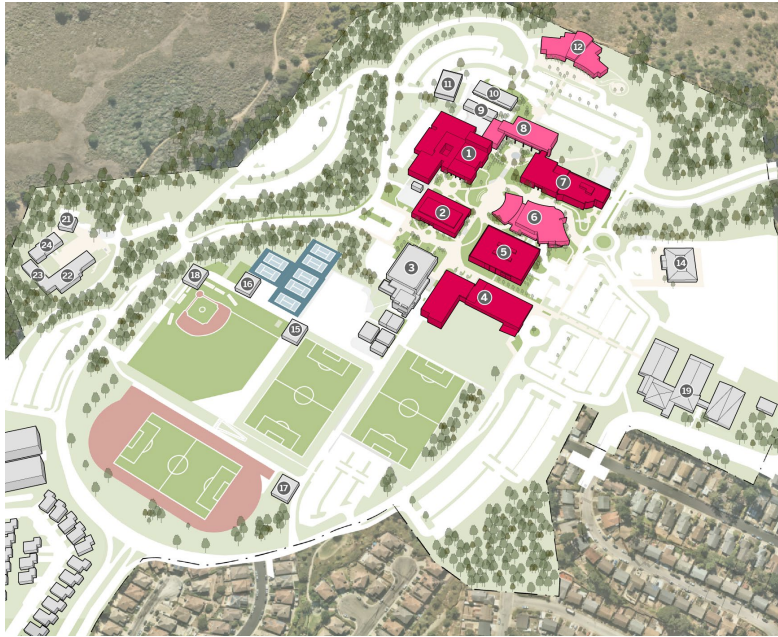

SKYLINE COLLEGE

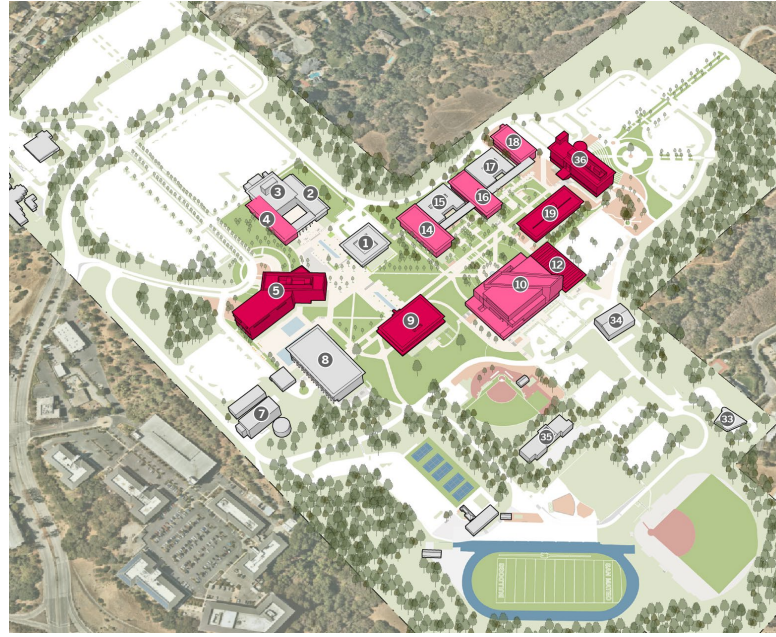

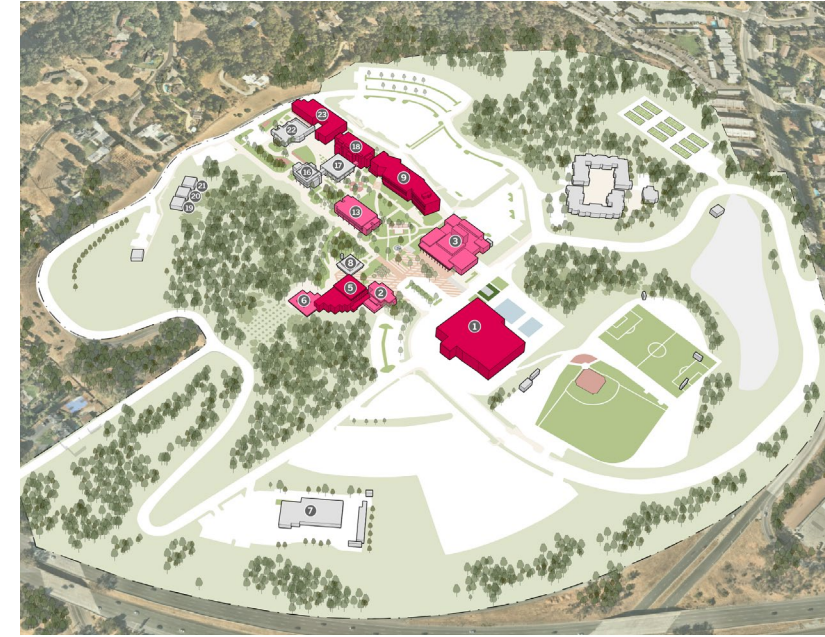

COLLEGE OF SAN MATEO



CAÑADA COLLEGE

**15 Spaces converted. Additional 20 will be added in B13**

-  Current HyFlex Locations
-  Proposed Add'l Locations

# WAYFINDING

- Recommendations to improve pedestrian and vehicular navigation experience
- Wayfinding for accessible routes
- Clear, welcoming building identification
- Signage lifecycle & maintenance recommendations

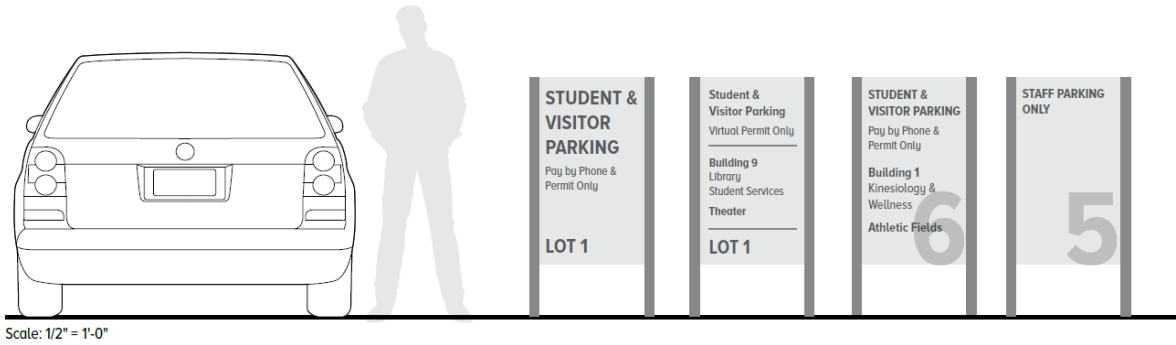

Existing Sign

Refined Layout

New Layout



- Existing Directories
- Additional Directories

# LONG TERM VISION





---

04

# LONG-TERM VISION

## Cañada College

- The long-term vision identifies opportunity areas for housing and future growth
- Ensures exciting future development results in a holistic, accessible, and connective campus

-  Potential Future Building Site
-  Potential Future Housing
-  Potential Future Childcare
-  Potential Site Improvements

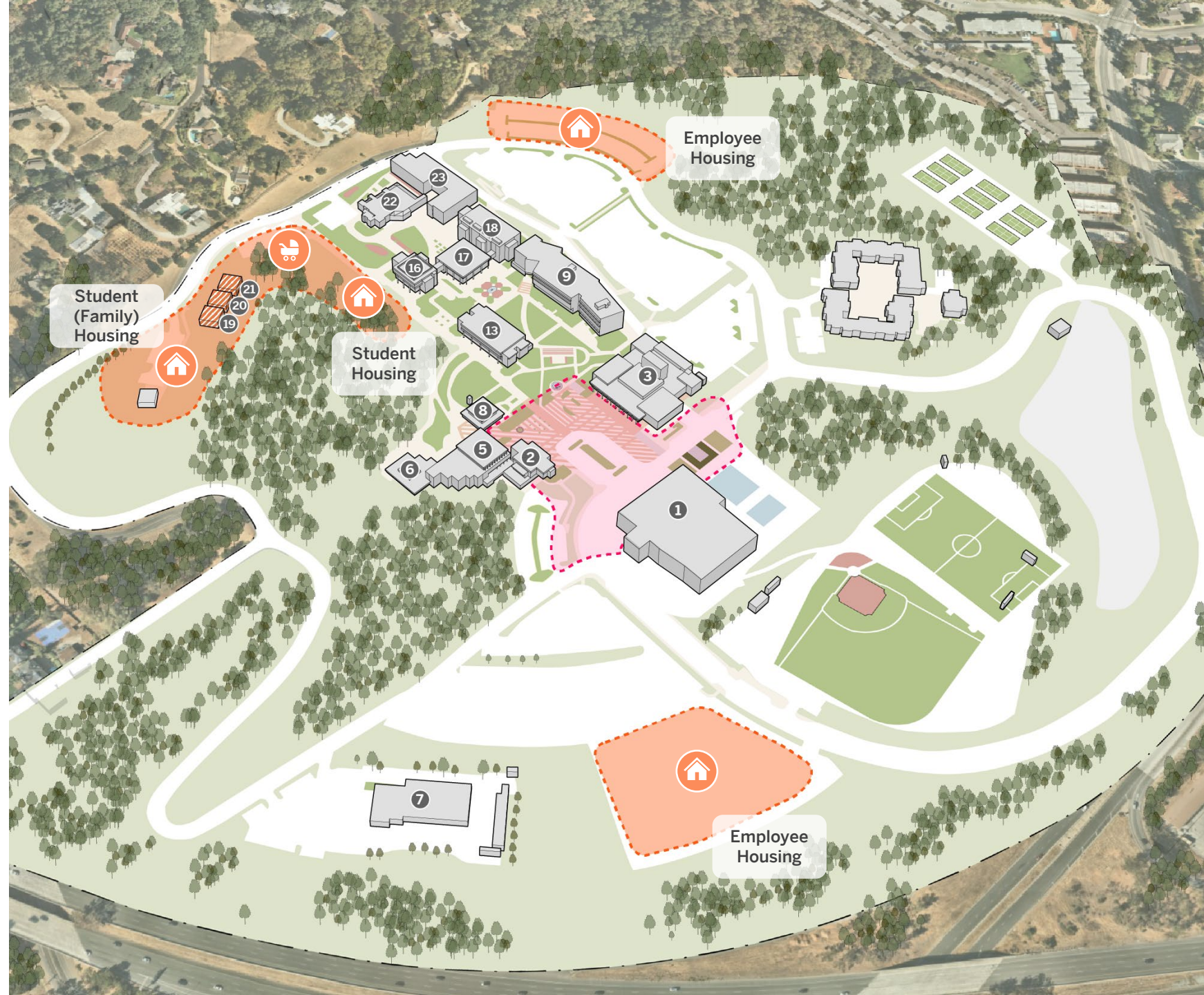

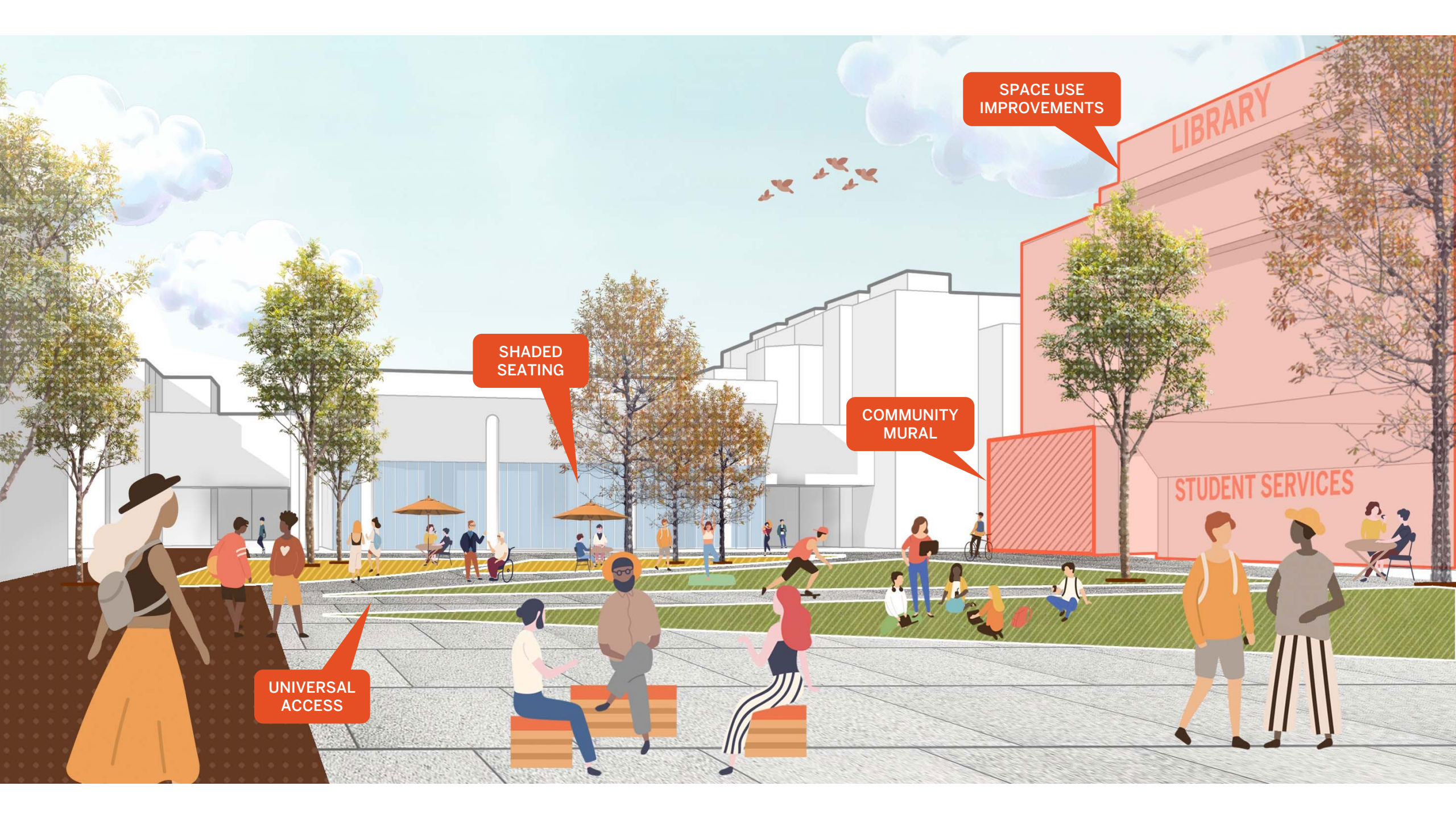

SPACE USE IMPROVEMENTS

SHADED SEATING

COMMUNITY MURAL

UNIVERSAL ACCESS

LIBRARY

STUDENT SERVICES

EVENT SPACES

WELCOMING  
SIGNAGE

SPACE USE  
IMPROVEMENTS

Science and  
Technology

18

16

ACTIVE GATHERING  
SPACES





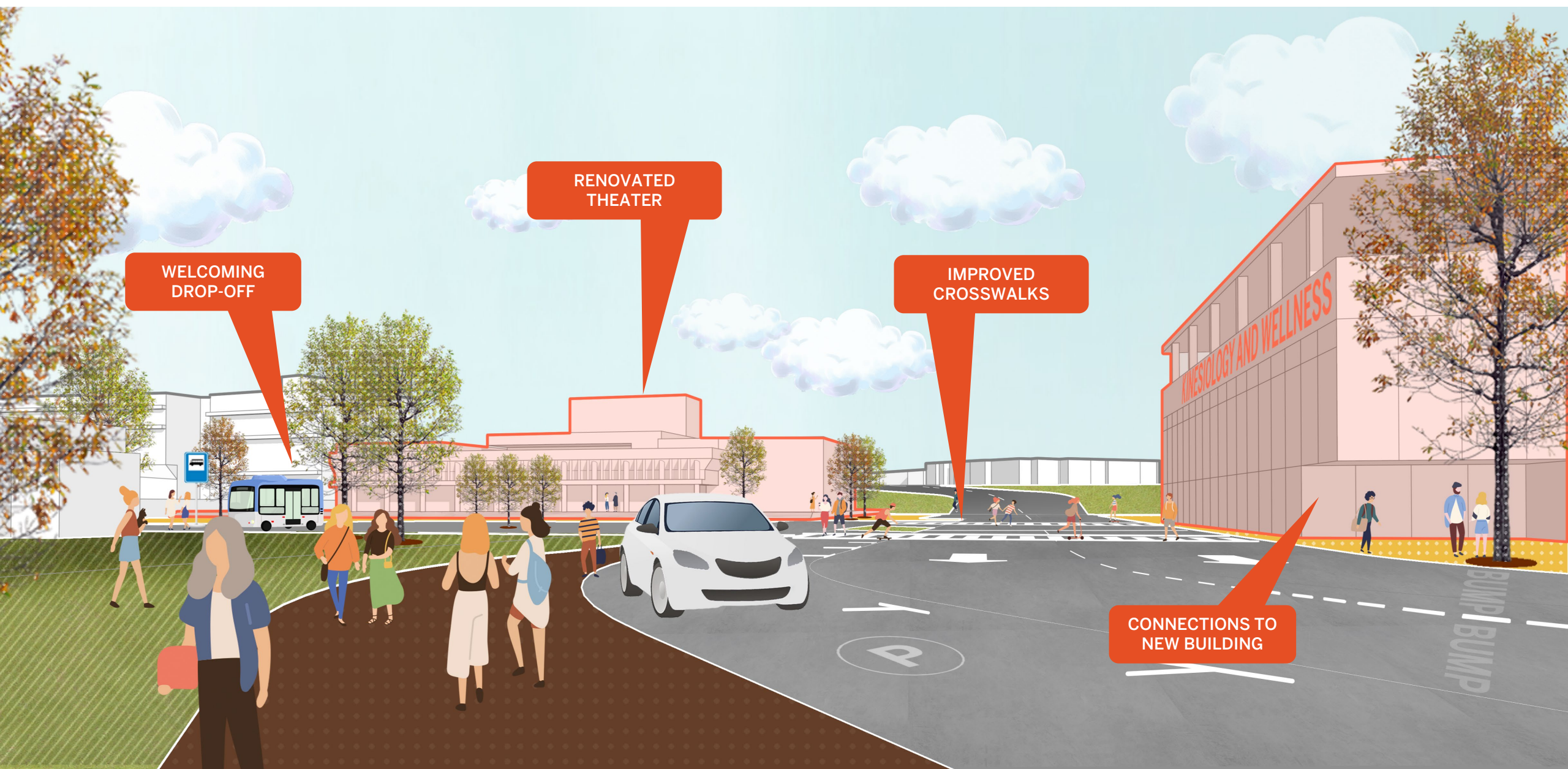

WELCOMING  
DROP-OFF

RENOVATED  
THEATER

IMPROVED  
CROSSWALKS

CONNECTIONS TO  
NEW BUILDING

KINESIOLOGY AND WELLNESS

BUMP  
BUMP

# THANK YOU TO OUR CONSTITUENTS!



College of San Mateo



- College Cabinet
- Associated Students of Cañada College
- Academic Senate
- Classified Senate
- ASLT Division
- Science & Technology Division
- Business, Design and Workforce Division
- Humanities and Social Science Division
- Kinesiology, Athletics and Dance Division
- Counseling Division
- Enrollment Services
- Planning, Research & Institutional Effectiveness (PRIE)
- Planning & Budgeting Council (PBC)
- Instructional Planning Council (IPC)
- Student Services Planning Council (SSPC)
- Equity and Antiracism Leadership Group
- Safety
- Technology & Distance Education Advisory Committees
- Community Forum

- President's Cabinet
- Management Council
- Associated Students
- Academic Senate
- Classified Senate
- PRIE and Equity
- Admissions and Records
- EOPS
- Welcome Center
- Disability Resource Center
- Promise Scholars
- Multicultural and Dream Center
- Student Life and Leadership
- International
- Institutional Planning Committee
- Health and Wellness
- Child Development Center
- Academic Support and Learning Technologies
- Math and Science
- Business & Technology
- Creative Arts and Social Science
- Kinesiology, Athletics and Dance
- Language Arts
- Administration of Justice & Fire Technology
- Community Forum

- President's Cabinet
- Management Council
- Associated Students
- Academic Senate
- Classified Senate
- Academic Support and Learning Technologies
- STEM
- Business Education, and Professional Programs
- Creative Arts and Social Science
- Kinesiology, Athletics and Dance
- Language Arts
- Counseling, Advising, and Matriculation
- Enrollment Services
- Global Learning Programs and Services
- Strategic Partnerships and Workforce Development
- Student Equity and Support Programs
- Strategic Planning and Allocation of Resources (SPARC)
- Stewardship Equity, Equal Employment, and Diversity (SEED)
- Advisory Committee for Employee Development (ACED)
- Health, Safety and Emergency Preparedness Committee
- Institutional Effectiveness Committee (IEC)
- Technology Advisory Committee (TAC)
- College Design Team
- Community Forum

# FEEDBACK

---